



— INTRODUCING —
LONAVILLAS
CUSTOMISED VILLAS FOR YOU

3&4 BHK
LUXURY ROW VILLAS



IDEAS THAT STAY WITH YOU

★ Puranik Builders Ltd. is a well-known real estate company providing comprehensive residential and commercial solutions for over **32 years**.

★ Puranik Builders Ltd., established in **1990**, has been successful in developing a noticeable amount of area within a short span of time.

★ At present, the group has successfully developed over **5,54,197 sq.mt.** area across **35** completed projects and **23** ongoing projects with an aggregate of **13,05,632 sq.mt.**

★ **17** forthcoming project area: **12,63,526 sq.mt.**



AWARDS & ACCOLADES

- 2020** ▶ Top thematic project was given to Rumah Bali by Optimal Media
- 2020** ▶ Top signature lifestyle project was given to Puraniks Abitante by Optimal media
- 2018** ▶ Real estate awards by Hindustan Times
- 2015** ▶ Corporate excellence award by Lokmat
- 2014** ▶ The best residential project was given to Puranik City by CNBC awards
- 2012** ▶ 13 Powerbrands' Rising star



YOUR SWEET SPOT

Weekend villas can be more than just a second home. At Puraniks Sayama, you discover luxurious villas that are a perfect stage to discover the best within, as you sample a world of enriching activities, cast your sight across verdant mountain panoramas, or just kick back and chill in the lap of peace and tranquillity. It's life, a cut above the rest.

PURANIKS
sayama
Lonavala



CUSTOMISED VILLAS FOR YOUR MODIFICATION

— INTRODUCING —
LONAVILLAS
CUSTOMISED VILLAS FOR YOU

POSSESSION GIVEN FOR
70+ VILLAS



PREMIER VILLAS

LIVE THE SPORTY LIFE

There is only one place for true aficionados of the sporty life, and it's the Premier Villa at Puraniks Sayama. Welcome to a unique space that brings the colour and magic of sports to life, and lets the sporty aesthetic seamlessly enhance your daily routine.

Picture shown above are images for representational purpose only, every design will be customised as per customers requirement & customer will have to pay an additional cost for the same, at the time of possession.



2

SYMPHONY VILLAS

DISCOVER THE HARMONY IN EXISTENCE

Luxury homes for those who hear the rhythm in everything. Presenting Symphony homes with tunes of peace in each corner. If you love music & eternity, this is the perfect villa for you.

Picture shown above are images for representational purpose only, every design will be customised as per customers requirement & customer will have to pay an additional cost for the same, at the time of possession.



3

MY VILLAS SHAPED IN YOUR OWN IMAGE

What makes you special? The answer lies in My Villa at Puraniks Sayama, where one's unique choices and personalities shape the homes they live in. From a plethora of luxurious options, and indulgent design cues, you get to pick what truly makes you.

Picture shown above are images for representational purpose only, every design will be customised as per customers requirement & customer will have to pay an additional cost for the same, at the time of possession.



4

VOYAGE VILLAS

FINE LIVING UNLOCKED

At Puraniks Sayama, there are no limits to aspirations. Especially for those who choose the Voyage Villa, beaming with bespoke luxury that elevates living standards to levels beyond imagination. And still leaves room for you to discover even more joy and indulgence.

Picture shown above are images for representational purpose only, every design will be customised as per customers requirement & customer will have to pay an additional cost for the same, at the time of possession.

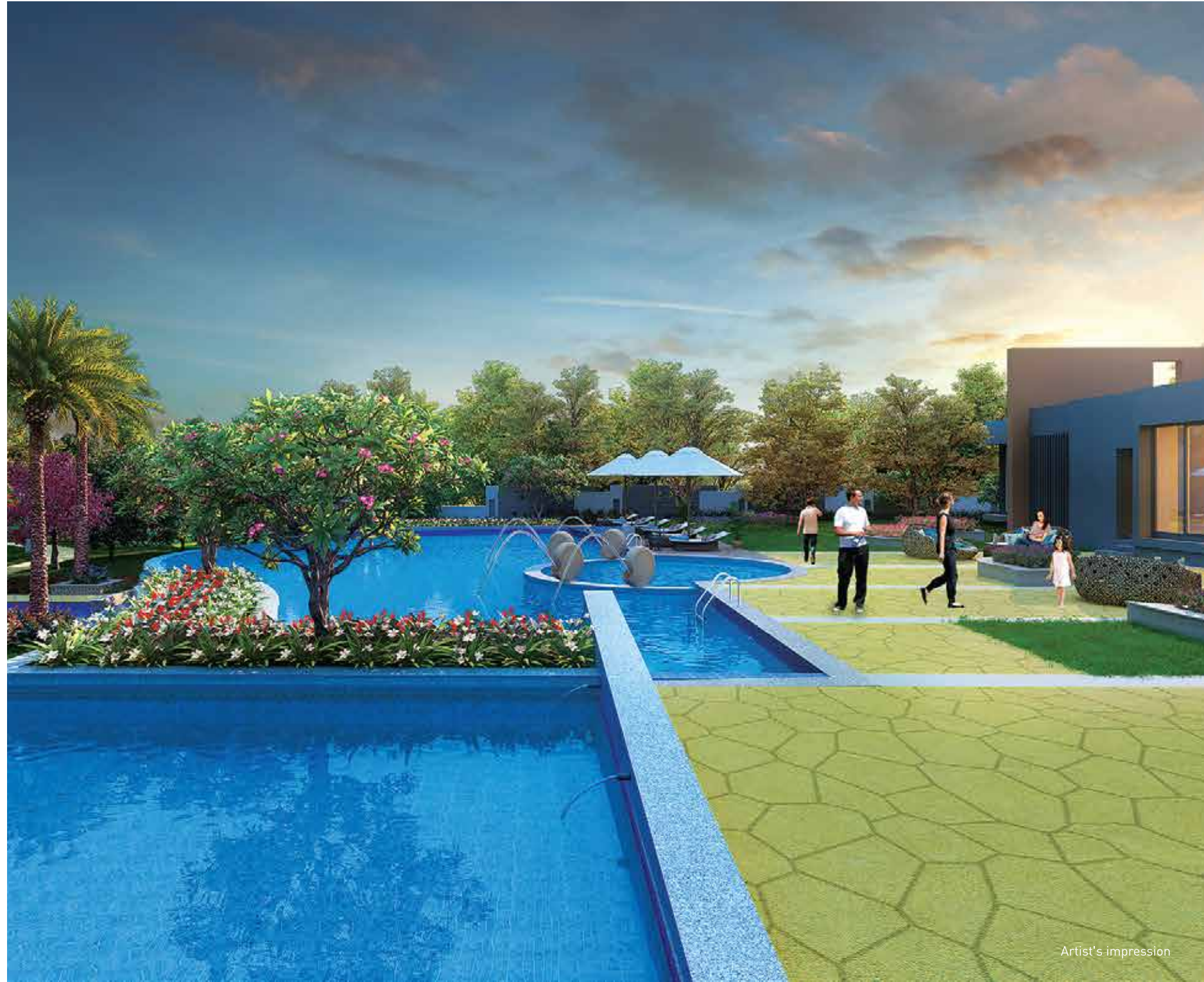

| SWIMMING POOL



| TENNIS LAWN



Actual image

| GAMES ROOM



Artist's impression

| CLUB HOUSE

LUXURY IS IN EACH DETAIL

- Private Garden
- Space for Cabana on the Terrace
- Party Space on the Terrace
- Plunge Pool (Select Row Villas)
- Children's Balcony
- Wooden finish Vitrified Flooring in Master Bedroom
- Vitrified Flooring in Passage, Living and Dining Rooms
- Best in class CP and Sanitary Fittings
- Standard Modular Switches
- Staircase artificial marble
- Stainless railing
- Home automation in living room and master bedroom
- Video door phone
- Solar panels for hot water



Actual image

MASTER CABANA



PLUNGE POOL



GREEN LAWNS

LOCATION ADVANTAGE

Main Market / Station / Bank / Hospital **900** Meters

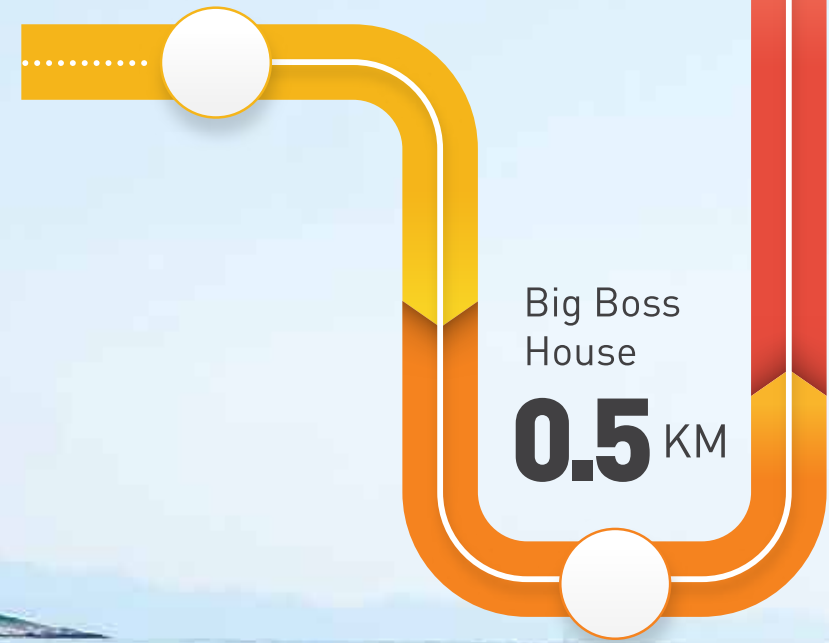

Kumar Resort **1.5** KM

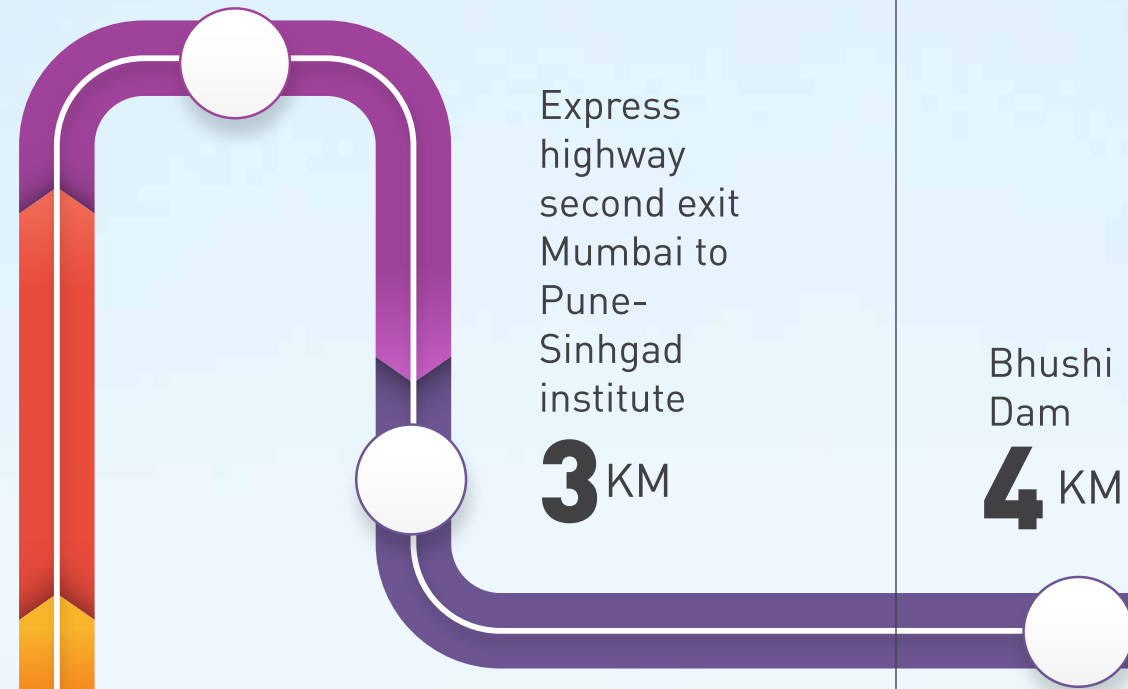

Bhushi Dam **4** KM



Express highway first exit From Mumbai to Pune - Kandala - **5** KM

Pawna Lake **11** KM

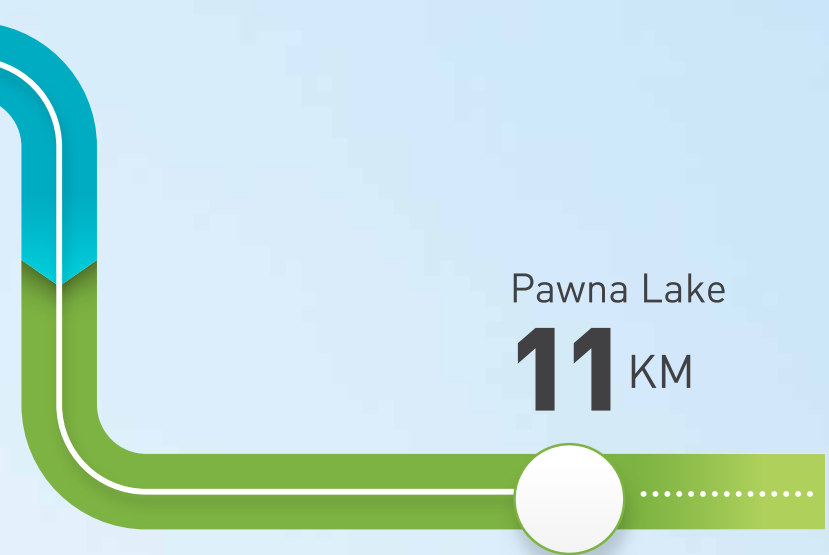

IN THE HEART OF **LONAVALA.**

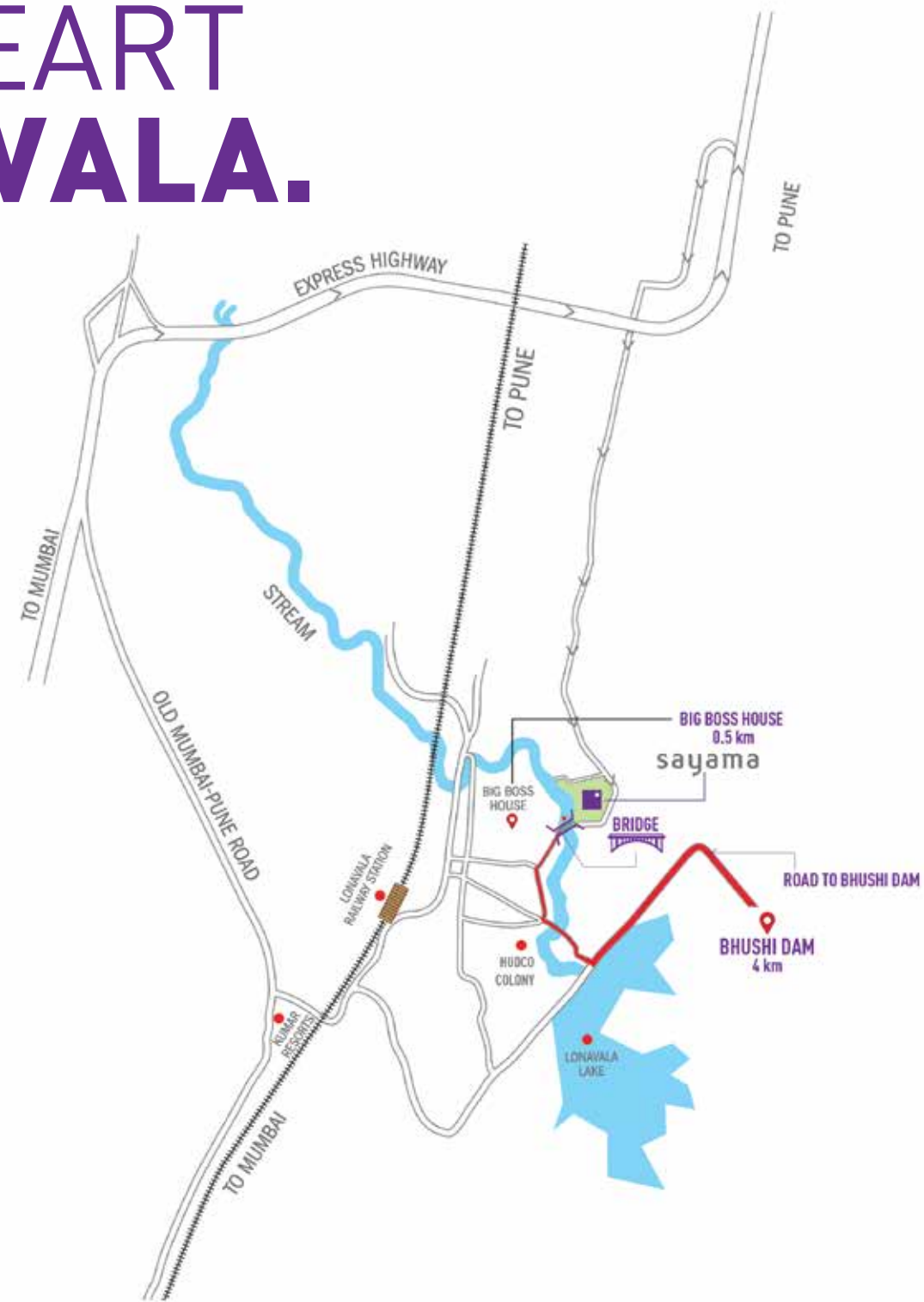

Map not to scale

NEARBY TOURIST **ATTRACTIONS**

- Sunil's Celebrity Wax Museum
- Karla Buddha Caves
- Bhushi Dam
- Monkey Point
- Lonavla Lake Waterfall
- Tiger Point
- Lions Point
- Visapur Killa
- Lonavla Lake

Image for representational purpose only



REASONS TO **BUY WITH US**



1 A villa that tells your story. Villas customized to suit your taste and personality

2 Fully functional clubhouse with all facilities you may need

3 Luxury without burning a hole in your pockets

4 Located in the heart of Lonavala giving you the best of both worlds: City and Suburbs

5 Puraniks Sayama offers top-of-the-line security in our gated community. All your safety concerns are taken care of by us

6 Ready external amenities

OUR VALUED CUSTOMERS

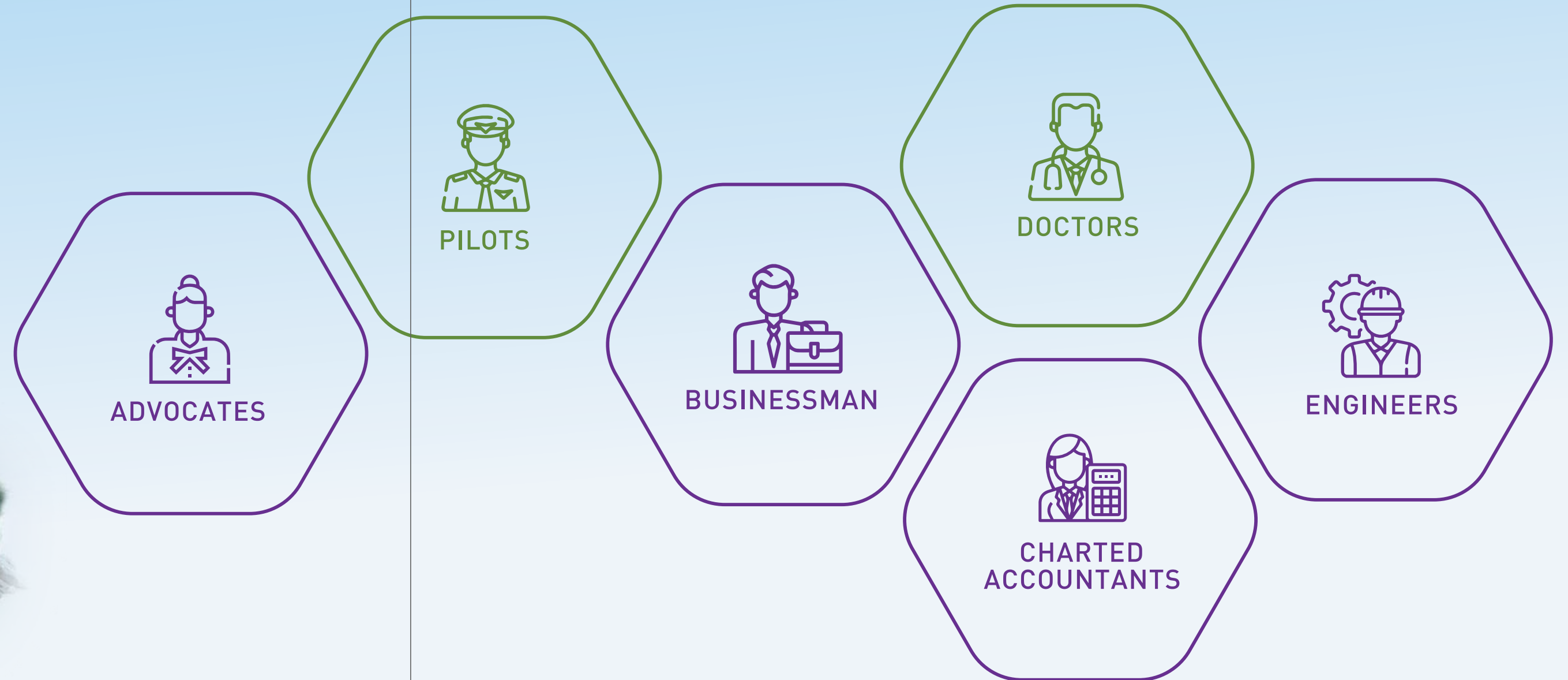

ADVOCATES

PILOTS

BUSINESSMAN

DOCTORS

CHARTED ACCOUNTANTS

ENGINEERS



Completed & OC Ready
 Available
 Future Development

MASTER LAYOUT

PHASE 1

1. MAIN ENTRY WITH SECURITY CABIN
2. PALM DRIVEWAY
3. SIGNAGE WALL
4. RESTING PAVILION
5. YOGA MEDITATION LAWN
6. AROMA GARDEN
7. UTILITY YARD

PHASE 2,3,4

8. SKATING RINK
9. FOCAL SCULPTURE
10. DRY STREAM GARDEN
11. TIMBER LOUNGE

12. FAMILY PLAZA
13. KIDS PLAY AREA
14. RIVERSIDE GATHERING PLAZA
15. REFLEXOLOGY AREA
16. TRELIS WALK WITH CREEPERS
17. MULTI-ACTIVITY LAWN
18. BARBEQUE COUNTER
19. TENNIS COURT
20. HALF BASKETBALL COURT
21. MAIN SWIMMING POOL
22. JACUZZI POOL
23. KIDS POOL
24. CLUBHOUSE WITH OPEN AIR LOUNGE



A-FIRST FLOOR PLANS

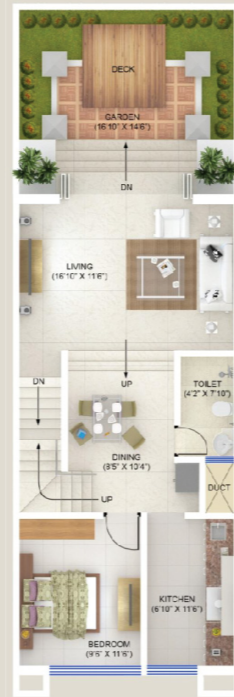

A-UPPER LEVEL FLOOR PLANS

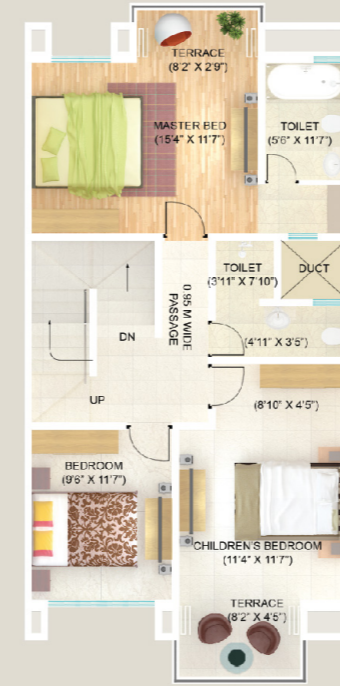

B-FIRST FLOOR PLANS

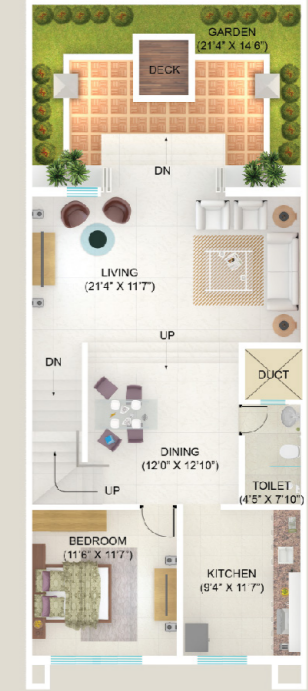

B-UPPER LEVEL FLOOR PLANS

FLOOR PLANS A

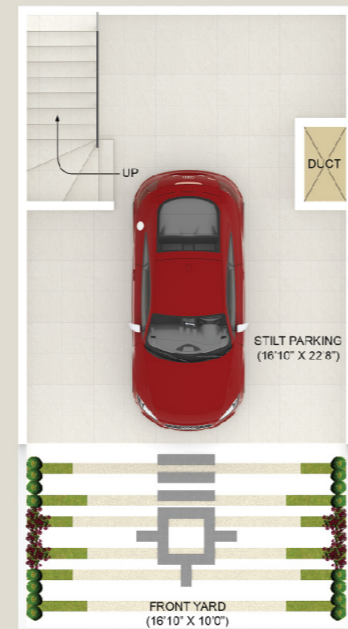

A-LOWER LEVEL FLOOR PLANS

FLOOR PLANS B

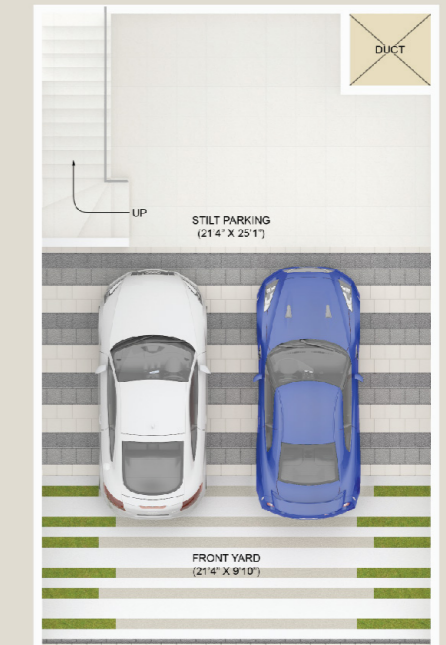

B-CAR PARKING FLOOR PLAN



 **022 6267 6825 | WWW.PURANIK-SAYAMA.COM**

Corporate Office : Puraniks One, Near Kanchanpushpa Complex, Ghodbunder Rd, opp. Suraj Water Park, Kavesar, Thane, Maharashtra 400615

Site Office : Sahyadri Nagar, Behind Hudco Colony, Bhangarwadi, Lonavla, Maharashtra 410401